

APPROVAL

TO: Etex Telephone Coop., Inc.
P.O. Box 130 Gilmer, TX 75644

DATE 05/21/2026

The Upshur County Commissioners Court offers no objections to the location on the right-of-way of your proposed New Fiber Optic line across BLUEBELL RD. as shown by accompanying drawings and notice dated Approved, except as noted below:

N/A

It is expressly understood that the Upshur County Commissioners Court does not purport, hereby, to grant and right, claim, title, or easement in or upon this county road; and it is further understood that in the future should for any reason Upshur County need to work, improve, relocate, widen, increase add to or any manner change the structure of this right-of-way line, this line, if affected, will be moved under the direction of the Upshur County Engineer and shall be relocated at the complete expense of the owner. Upshur County shall be notified a minimum of 48 hours prior to the beginning of any work.

All work on the county right-of-way shall be performed in accordance with the County Engineer's instructions. The installation shall not damage any part of the highway and adequate provisions must be made to cause minimum inconvenience to traffic and adjacent property owners. Special specifications for placing this line are as follows:

1. All ground lines are to be installed a minimum of 36 inches below the flowline of the adjacent drainage or borrow ditch.
2. All excavations within the right-of-way and not under surfacing shall be backfilled by tamping in 6 inch horizontal layers. All surplus material shall be removed from the right-of-way and the excavation finished flush with surrounding natural ground.
3. Lines crossing under surfaced roads and under surfaced cross roads within the right-of-way shall be placed by boring. Boring shall extend from crown line to crown line.
4. All lines under roads carrying pressure in excess of 50 psi shall be enclosed in satisfactory casing extending from right-of-way line to right-of-way line. Pipe used for casing may be of any type approved by the County Engineer and shall be capable of Supporting the load of roadbed and traffic and shall be so constructed that there will be no leakage of any matter through the casing for its entire length. Inside diameter of casing shall be at least 2 inches greater than the largest outside diameter of carrier pipe, joint or couplings. (Encasement is not required on lines installed 48 inches or greater below flowline.)
5. All lines, where practicable, shall be located to cross roadbed at approximately right angles thereto. No lines are to be installed under or within 50 feet of either end of a bridge unless approved by the County Engineer in writing. No lines shall be placed inside any culvert or within 10 feet of the closest point of same.
6. Parallel lines will be installed as near the right-of-way lines as is possible and no parallel line will be installed in the roadbed or between the drainage ditch and roadbed unless approved by the County Engineer in writing.
7. Overhead lines will have a minimum clearance of 18 feet above the road surface at point of crossing.
8. Operations along roadways shall be performed in such a manner that all excavated material be kept off the pavements at all times, as well as all operating equipment and materials. Do not use equipment or installation procedures which will damage any road surface or structure. The cost of any repairs to road surfaces, roadbed, structures or other right-of-way features as direct result of this installation will be borne by the owner of this line.
9. Barricades, warning signs, lights and flagmen, when necessary, shall be provided by the contractor or owner. One half of the traveled portion of the road must be open to traffic at all times. All traffic control shall be in accordance with the requirements of the current version of the Texas MUTCD.
10. Utility company shall install adequate erosion control measures for any excavation work being performed.

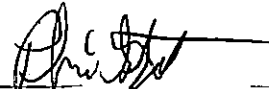
APPROVED: 
Road Administrator

APPROVED: _____
Chairperson, Upshur County Commissioners Court

NOTICE OF PROPOSED INSTALLATION
NOTICE OF PROPOSED INSTALLATION

PIPE AND/OR UTILITY LINES

DATE: 05/21/2026

TO: UPSHUR COUNTY COMMISSIONERS COURT
c/o UPSHUR COUNTY ENGINEER
UPSHUR COUNTY ROAD & BRIDGE DEPARTMENT
P. O. BOX 730
Gilmer, TX 75644

EXPIRES: 10/1/2026

Formal notice is hereby given that Etex Telephone Coop., Inc. proposes to bore a New Fiber Optic line within the right-of-way of County Roads BLUEBELL RD. as follows: Installing new fiber and duct on both sides of said county roads. All construction will be directionally bored at a min depth of 60" within the Upshur county Road and Bridge right-of-way.

The location and description of the proposed line and appurtenances is more fully shown by three copies of drawings attached to this notice. The line will be constructed and maintained on the County right-of-way as directed by the County Engineer in accordance with current Upshur County specifications.

Construction of this line will begin on or after the 25th day of MAY, 2026 and will be completed within 120 days of the date of approval.

Firm Etex Telephone Coop., Inc.
By JASON ALLEN
Title Right-of-way solicitor
Address P.O. Box 130 Gilmer, TX 75644

- NOTE: 1. This form to be submitted in triplicate for each proposed installation.
2. The permit shall be in effect until the utility line is removed from the right of way.
3. Inform the County Engineer if work is not completed within this time

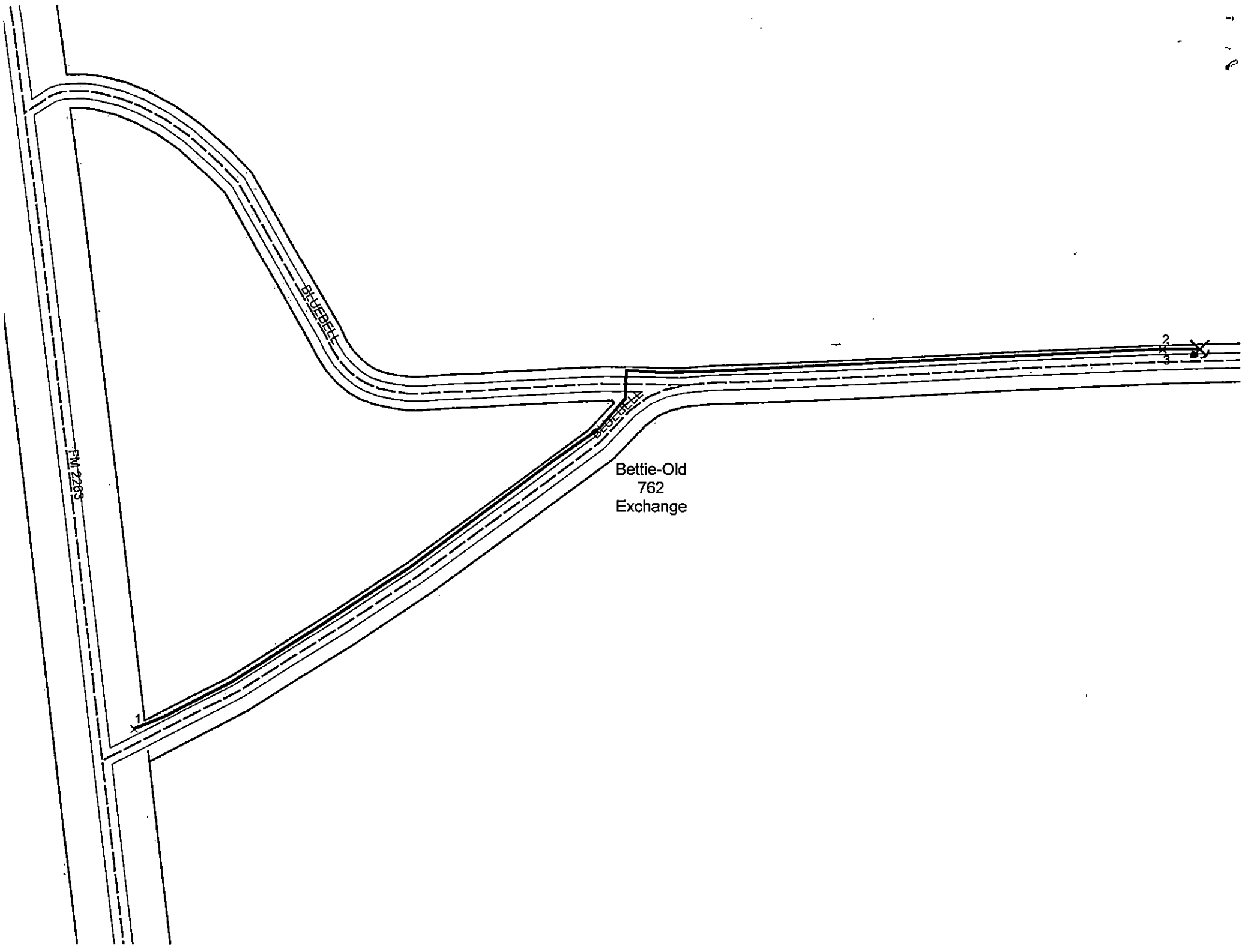

BLUEBEL

FM 2295

1

BLUEBEL

Bettie-Old
762
Exchange

2
3

APPROVAL

TO: Etex Telephone Coop., Inc.
P.O. Box 130 Gilmer, TX 75644

DATE 05/20/2026

The Upshur County Commissioners Court offers no objections to the location on the right-of-way of your proposed New Fiber Optic line across BOAR AND COUGAR RD., as shown by accompanying drawings and notice dated Approved, except as noted below:

N/A

It is expressly understood that the Upshur County Commissioners Court does not purport, hereby, to grant and right, claim, title, or easement in or upon this county road; and it is further understood that in the future should for any reason Upshur County need to work, improve, relocate, widen, increase add to or any manner change the structure of this right-of-way line, this line, if affected, will be moved under the direction of the Upshur County Engineer and shall be relocated at the complete expense of the owner. Upshur County shall be notified a minimum of 48 hours prior to the beginning of any work.

All work on the county right-of-way shall be performed in accordance with the County Engineer's instructions. The installation shall not damage any part of the highway and adequate provisions must be made to cause minimum inconvenience to traffic and adjacent property owners. Special specifications for placing this line are as follows:

1. All ground lines are to be installed a minimum of 36 inches below the flowline of the adjacent drainage or borrow ditch.
2. All excavations within the right-of-way and not under surfacing shall be backfilled by tamping in 6 inch horizontal layers. All surplus material shall be removed from the right-of-way and the excavation finished flush with surrounding natural ground.
3. Lines crossing under surfaced roads and under surfaced cross roads within the right-of-way shall be placed by boring. Boring shall extend from crown line to crown line.
4. All lines under roads carrying pressure in excess of 50 psi shall be enclosed in satisfactory casing extending from right-of-way line to right-of-way line. Pipe used for casing may be of any type approved by the County Engineer and shall be capable of Supporting the load of roadbed and traffic and shall be so constructed that there will be no leakage of any matter through the casing for its entire length. Inside diameter of casing shall be at least 2 inches greater than the largest outside diameter of carrier pipe, joint or couplings. (Encasement is not required on lines installed 48 inches or greater below flowline.)
5. All lines, where practicable, shall be located to cross roadbed at approximately right angles thereto. No lines are to be installed under or within 50 feet of either end of a bridge unless approved by the County Engineer in writing. No lines shall be placed inside any culvert or within 10 feet of the closest point of same.
6. Parallel lines will be installed as near the right-of-way lines as is possible and no parallel line will be installed in the roadbed or between the drainage ditch and roadbed unless approved by the County Engineer in writing.
7. Overhead lines will have a minimum clearance of 18 feet above the road surface at point of crossing.
8. Operations along roadways shall be performed in such a manner that all excavated material be kept off the pavements at all times, as well as all operating equipment and materials. Do not use equipment or installation procedures which will damage any road surface or structure. The cost of any repairs to road surfaces, roadbed, structures or other right-of-way features as direct result of this installation will be borne by the owner of this line.
9. Barricades, warning signs, lights and flagmen, when necessary, shall be provided by the contractor or owner. One half of the traveled portion of the road must be open to traffic at all times. All traffic control shall be in accordance with the requirements of the current version of the Texas MUTCD.
10. Utility company shall install adequate erosion control measures for any excavation work being performed.

APPROVED: 
Road Administrator

APPROVED: _____
Chairperson, Upshur County Commissioners Court

NOTICE OF PROPOSED INSTALLATION

NOTICE OF PROPOSED INSTALLATION
PIPE AND/OR UTILITY LINES

DATE: 05/20/2026

TO: UPSHUR COUNTY COMMISSIONERS COURT
c/o UPSHUR COUNTY ENGINEER
UPSHUR COUNTY ROAD & BRIDGE DEPARTMENT
P. O. BOX 730
Gilmer, TX 75644

EXPIRES: 10/20/2026

Formal notice is hereby given that Etex Telephone Coop., Inc. proposes to bore a New Fiber Optic line within the right-of-way of County Roads BOAR AND COUGAR RD., as follows: Installing new fiber and duct on both sides of said county roads. All construction will be directionally bored at a min depth of 60" within the Upshur county Road and Bridge right-of-way.

The location and description of the proposed line and appurtenances is more fully shown by three copies of drawings attached to this notice. The line will be constructed and maintained on the County right-of-way as directed by the County Engineer in accordance with current Upshur County specifications.

Construction of this line will begin on or after the 17th day of April, 2023 and will be completed within 120 days of the date of approval.

Firm Etex Telephone Coop., Inc.
By JASON ALLEN
Title Right-of-way solicitor
Address P.O. Box 130 Gilmer, TX 75644

- NOTE: 1. This form to be submitted in triplicate for each proposed installation.
2. The permit shall be in effect until the utility line is removed from the right of way.
3. Inform the County Engineer if work is not completed within this time

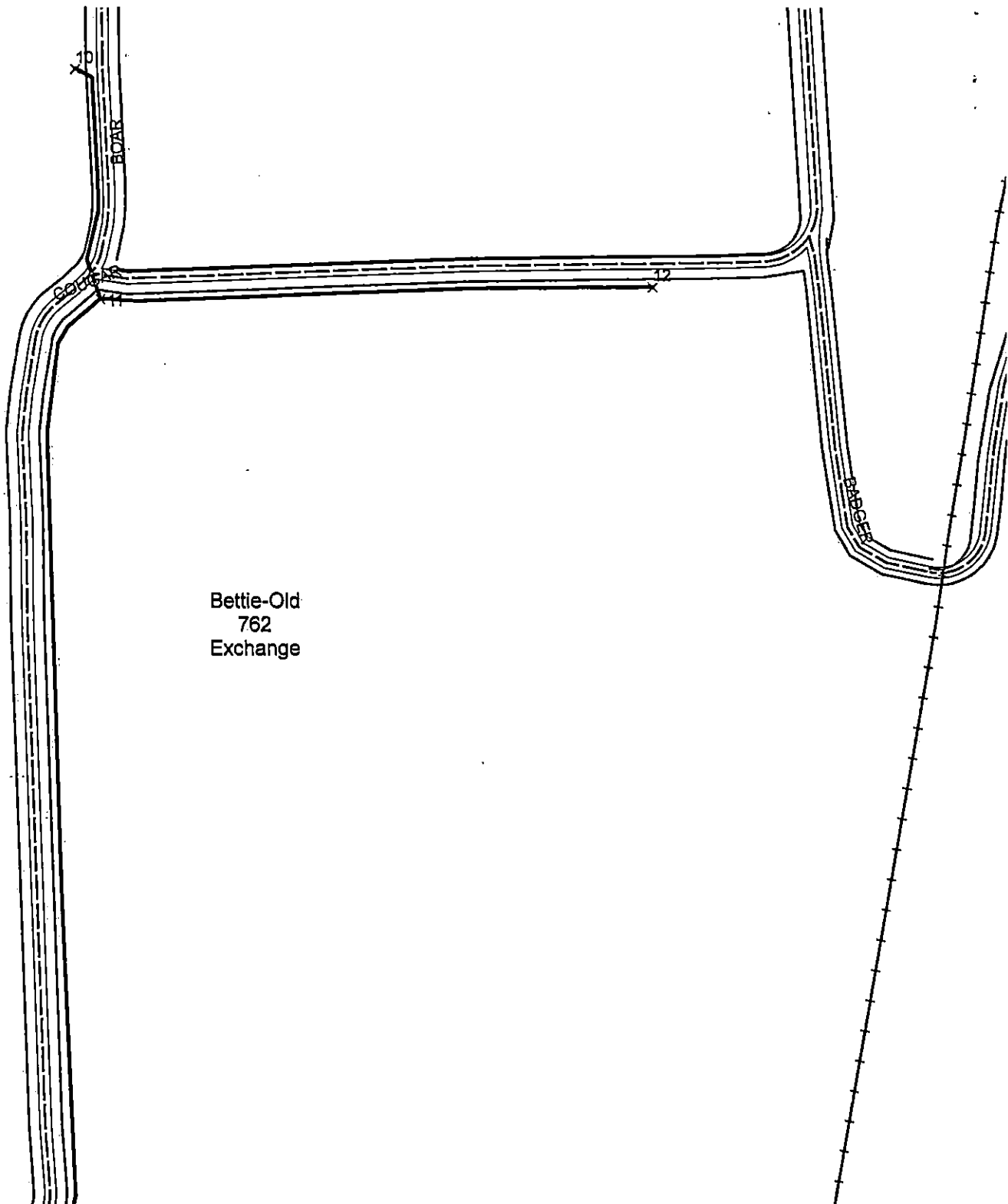

Bettie-Old
762
Exchange

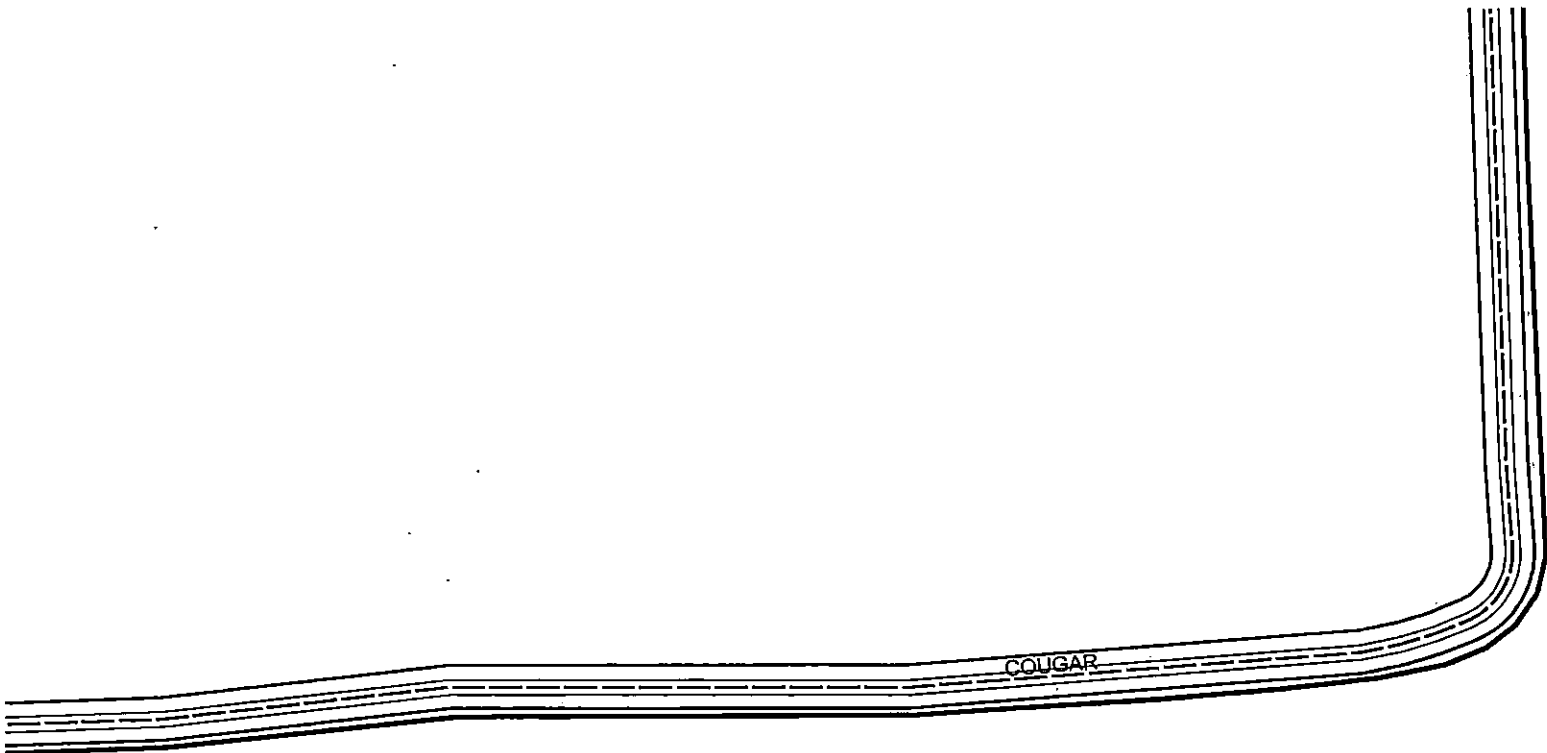

COUGAR

Bettie-Old
762
Exchange

COUGAR

Bettie-Old
762
Exchange

CHRYSLER

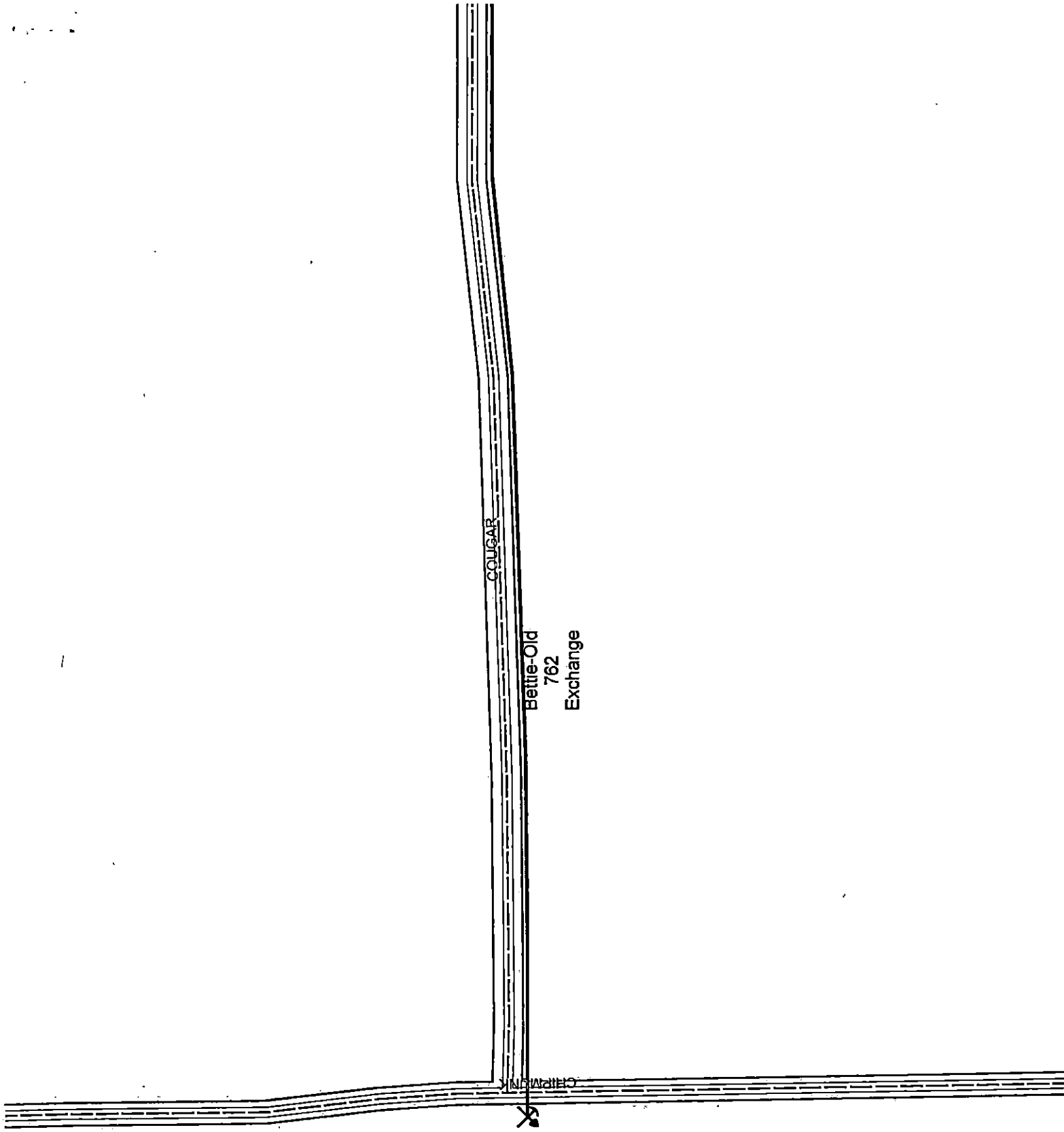

DRIVEWAY PERMIT APPLICATION

TO: THE UPSHUR COUNTY COMMISSIONERS COURT
COUNTY OF UPSHUR
GILMER, TEXAS

PRECINCT 4

DATE May 18, 2026

Formal notice is hereby given that Clayton Palmer, whose principal address is 107 Foxtail Ln, Gilmer, TX 75645 does hereby purpose to place a driveway culvert within the ROW of County Road Machen. Proposed construction will begin, if approved, on or after the 31st day of May, 2026. I, Clayton Palmer, hereby attest that I have read the conditions set forth in this application and understand its contents. The culvert X will/___ will not be placed by County equipment and personnel. This is a X new installation ___ extension.

SIGNATURES: _____

TELEPHONE: 903-736-6326

APPROVAL OF PERMIT APPLICATION

The Upshur County Commissioners Court offers no objection to the location on the right of way of your proposed driveway culvert for the address shown above. The proposed driveway structure will be a 15" x 20' culvert.

Recommended by _____

APPROVED ON THIS 18 DAY OF _____

5, 2026

Kellie Hunt
First Party Signature

PO Box 211
Street or Box

Gilmer, TX 75644
City, State and Zip Code

903-790-7317
Telephone

Institute of Basic Life Principles
Timber Tract / Property Owner

Issued by Amanda Sullivan Valid May 13, 2026 to August 13, 2026

PERMIT ISSUED NOT TO EXCEED 90 DAYS UNLESS OTHERWISE NOTED

COPY OF THIS PERMIT MUST BE IN EVERY TRUCK BEING USED

*****A TEMPORARY CULVERT MUST BE INSTALLED IN DITCH BEING
USED FOR ACCESS TO LAND*****

Kelli Hunt

First Party Signature

PO Box 211
Street or Box

Gilmer, TX 75644
City, State and Zip Code

903-790-7317
Telephone

Institute of Basic Life Principles
Timber Tract / Property Owner

Issued by Amanda Sulllivan Valid May 13, 2026 to August 13, 2026

PERMIT ISSUED NOT TO EXCEED 90 DAYS UNLESS OTHERWISE NOTED

COPY OF THIS PERMIT MUST BE IN EVERY TRUCK BEING USED

*****A TEMPORARY CULVERT MUST BE INSTALLED IN DITCH BEING
USED FOR ACCESS TO LAND*****